



Pacific Northwest Division

LOGGER

January/February 2008

Reminder – New Fees for 2008

The membership voted at the business meeting held in Chehalis in October to raise the Registration Fees and Table Fees starting in 2008.

(See the excerpts below from the minutes included with the November/December Logger.)

Train Collectors Association / Pacific Northwest Division 10/28/07; Minutes of the General Membership Meeting, Blue Pavilion – SW Washington Fairgrounds, Chehalis, Washington

A motion from the floor:

Proposed to increase the PNWD membership dues to \$15.00 a year and the Division meet fee to \$10.00 effective January 1, 2009.

An amendment from the floor to the previously approved motion (increase dues and the meet fee):

Proposed to make the \$10.00 Division meet fee effective January 1, 2008 (vs. 2009).

The amendment was seconded, discussed, and **approved** by a verbal vote.

A motion from the floor:

Proposed to increase the table fees at Division meets to \$15.00 a table effective January 1, 2008.

The motion was seconded, discussed, and **approved** by a verbal vote.

Due to the flooding of the fairgrounds in Chehalis in December, the location for the February 10, 2008 PNW Division meet will be held at the Lake City Community Center, 12531 – 28th Ave. NE, Seattle, WA.

Register Early – the form is included in this issue of the Logger.

Pre-registrations must be received by January 31st, 2008

BRING YOUR TRAINS TO TRADE OR SELL

HOWEVER, DUE TO THE LIMITED SPACE IN THIS HALL, THERE WILL BE APPROXIMATELY 60 TABLES AVAILABLE.

THE SAME RULES WILL APPLY IN LAKE CITY THAT HAVE ALWAYS BEEN FOLLOWED AT THE SOUTHWEST WASHINGTON FAIRGROUNDS IN CHEHALIS – SET UP YOUR TABLE, COVER THE TRAINS AND VACATE THE TRADING AREA – NO EXCEPTIONS.

This is the same location where the Seattle Chapter meets on the 4th Sunday of each month.

See map on Page 3

Dave Walsh
V. Pres. & Meet Czar

TCA Mission

To develop an appreciation of and to preserve an important segment of history – Tinplate Toy Trains – through research, education, community outreach, fellowship, establishment of collecting standards, and to promote the growth and enjoyment of collecting and operating toy, model and scale trains

The views expressed by the contributors to this publication are theirs and not necessarily the view of the Editor, Pacific Northwest Division or the Train Collector's Association.

President

Frank Geczi
12508-206th Pl. S. E.
Issaquah, WA 98027
Phone: 425-271-1547
e-mail: frankgeczi@aol.com

Vice President

David Walsh
4122 No. Gove
Tacoma, WA 985097
Phone: 253-756-8841
e-mail: pwalsh1000@hotmail.com

Secretary

Richard E. Walters
58515 71st Ave. W.
University Place, WA 98407
Phone: 253-7565-2371
e-mail: walters1221@comcast.net

Treasurer/Logger Editor

Barbara Flinchbaugh
36066-57th Ave. So.
Auburn, WA 98001
Phone: 253-939-2228
Fax: 253-804-3561
e-mail: rflinchbau@aol.com

Seattle Chapter President

J. Michael Bowerman
4410 23rd PL SW
Mountlake Terrace, WA 98043
Phone: 425-778-8750
e-mail: jmbowerman@msn.com

Portland Chapter President

Steve D'Ambrosia
21920 SE Mark Road
Clackamas OR 97015-8756
Phone - 503-658-4383
email - slincoln52@comcast.net

Treasure Valley Chapter President

Bill von Tagen
1114 N. 7th
Boise, ID 83702
Phone: 208-345-1728
e-mail: wvontagen@msn.com

PNWD BOD Members at Large

Steve Ramsdell
3886 NE Roosevelt St.
Bremerton, WA 98311-9633
Phone: 360-478-6435
e-mail: sstgram@earthlink.net

Dennis Tichi
P.O. Box 529
Woodinville, WA 98072-1005
Phone: 425-788-8910
e-mail: goofytrainman@msn.com

THE PRESIDENT'S MESSAGE



The 2 day October public meet at Chehalis was a success for the attendees. There was a member only silent auction and sales between the members before the public was allowed to enter. However, the public attendance was a little disappointing on both Saturday and Sunday.

The Treasure Valley Chapter brought their "hands-on-layout" for children to operate, which was supported by the Seattle and Portland Chapters. The Treasure Valley chapter layout reflects the current interest of computer-savvy kids and provides them an educational opportunity to learn how to operate trains with walk-around remotes.

The next PNWD meet will be held at the Chehalis Lake City Community Center on February 10. Due to the flooding in December at the Chehalis fair grounds, 16 feet of water, the facilities will not be ready for our winter meet. The registration forms are included in this news letter. We are providing a free table with registration for this meet only. You **must** pre-register and check the box to get the free table. The summer meet is still scheduled to occur at the Chehalis fairgrounds in June.

Elections for some PNWD officers occurred this year in October. The PNWD went to two year terms for elected officers in 2003. Because of the 2 year terms, the PNWD agreed to alternate the elections to elect the Vice President, Secretary and a member at large one year and the President, Treasurer and a member at large would be elected the following year. The PNWD current officers are:

<u>Officer</u>	<u>Assignee</u>	<u>Expiration Date</u>
President	Frank Geczi	December 2008
Vice President	Dave Walsh	December 2009
Treasurer	Barbara Flinchbaugh	December 2008
Secretary	Dick Walters	December 2009
Member-at-Large	Steve Ramsdell	December 2008
Member-at-Large	Dennis Tichi	December 2009

Members need to start thinking of volunteering to fill the positions that will be vacated the end of this year.

Here's looking forward to a rewarding 2008 collecting and operating toy trains for the enjoyment of both children and adults in our area..

Respectfully Submitted

Frank Geczi
President of the PNWD TCA



A 2008 LATE DUES FORM IS INCLUDED FOR ALL THE MEMBERS WHO HAVE NOT AS YET PAID THEIR DUES. YOUR NAME WILL BE HIGHLIGHTED ON THE ADDRESS LABEL .

ALL MEMBERS WHO ARE NOT CURRENT WITH THEIR DUES BY FEBRUARY 15, 2008 WILL BE DROPPED FROM THE LIST.

WANTED

3472 junker milk car OR
Working mechanism.

Please contact:
Bill Hollingsworth

425-393-1104

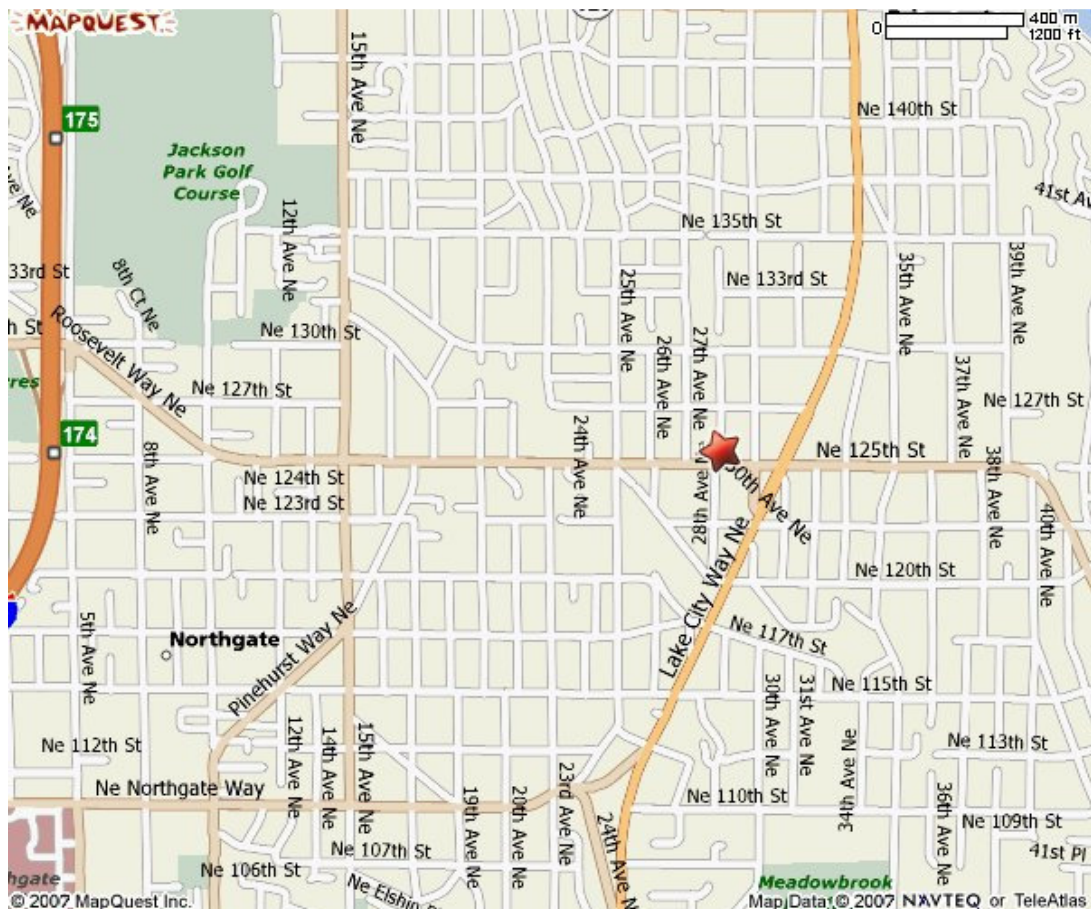

THERE WAS NO ACTIVITY INPUT FROM THE THREE CHAPTERS. THIS “LOGGER” WILL SERVE ONLY AS A NOTICE FOR THE FEBRUARY 10TH 2008 DIVISION MEET BEING HELD AT THE LAKE CITY COMMUNITY CENTER IN LAKE CITY – SEE MAP ABOVE.

FIRST CLASS MAIL

Barbara Flinchbaugh, Editor
 Train Collectors Association
 Pacific Northwest Division
 36066-57th Ave. So.
 Auburn, WA 98001-9306



REMEMBER
YOU CAN SEE THE LOGGER IN
BEAUTIFUL COLOR – JUST LOG ON TO
OUR WEBSITE: www.traincollector.org
ENTER THE SITE & click on
NEWSLETTERS - - ENJOY!!!

CALENDAR OF EVENTS

Portland Chapter Meets

The Portland Chapter meets are held the 3rd Sunday of the month at the Aloha Mall, 18631 SW Tualatin Valley Highway @ corner of SW 185th Ave., Aloha, OR 9:00 AM to 1:00 PM, Meeting and Auction, Contact - - Steve D'Ambrosia, 503-658-4383

Seattle Chapter Meets

The Seattle Chapter meets are held the 4th Sunday of the month at the Lake City Community Center, 12531-28th Ave. NE, Seattle WA, Doors open 9:00 AM, Contact - - Mike Bowerman. 425-778-8750